

# MEGGITT CITEC

POTENTIOMETERS  
INDUCTORS, SMDS  
SWITCHES, NETWORKS  
ENCODERS  
POWER COMPONENTS

---

## Linear Slide Potentiometers

### TYPE WA SERIES

---

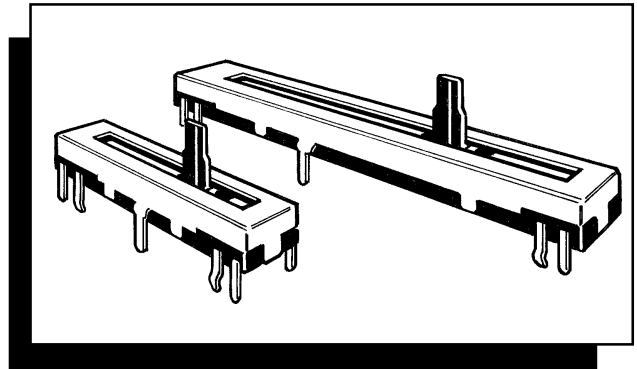

A family of high reliability Slide Potentiometers having a range of metal or insulated levers and are offered in single or dual outputs.

The WA Series utilizes the very latest inset moulding technology to produce a slider with excellent "feel" and range of throw and body lengths with linear or non linear outputs.

---

### MEGGITT CITEC KEY FEATURES

- LATEST INSET MOULDED TECHNOLOGY
- LINEAR OR NON-LINEAR OUTPUTS
- 15mm TO 60mm THROWS
- CONSISTENT SMOOTH FEEL
- PLASTIC OR METAL LEVER
- SUITABLE FOR WAVE SOLDER
- EARTH SCREEN PLATE
- AVAILABLE VIA DISTRIBUTION

## ELECTRICAL

Resistance Range:	5K to 100K
Resistance Tolerance:	± 20%
Output Law:	Linear & Logarithmic
Voltage Rating:	$E = \sqrt{P \times R}$
Electrical Life:	15,000 cycles
Insulation Resistance:	10 Meg minimum @ 250V DC
Dielectric Withstand Voltage:	300VAC

Rated Dissipation:

Travel (T)	Power @ 50°C		Max. Operating Voltage	
	Lin	Log	Lin	Log
15mm	0.03W	0.02W	75V	75V
20mm	0.04W	0.02W	150V	150V
30mm	0.06W	0.03W	150V	150V
45mm	0.10W	0.05W	200V	150V
60mm	0.12W	0.06W	200V	200V

## DIMENSIONS

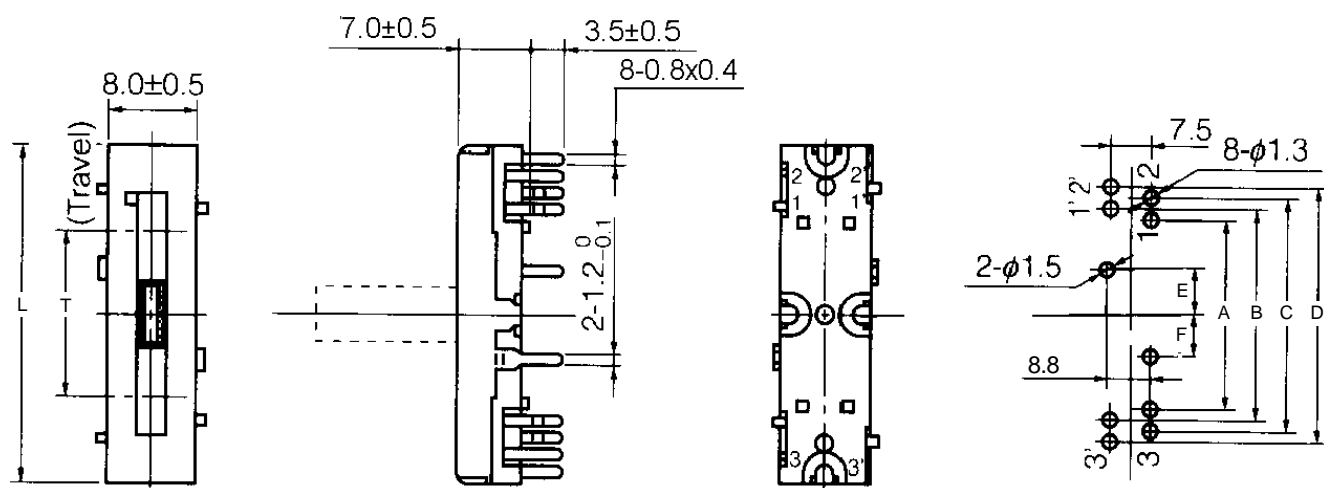

Travel (T)	A	B	C	D	E	F	L
15mm	19.00	22.00	25.00	28.00	4.00	4.00	30.00
20mm	24.00	27.00	30.00	33.00	0.00	2.00	35.00
30mm	34.00	37.00	40.00	43.00	0.00	5.00	45.00
45mm	49.00	52.00	55.00	58.00	0.00	5.00	60.00
60mm	64.00	67.00	70.00	73.00	6.00	11.00	75.00

## LEVER STYLE

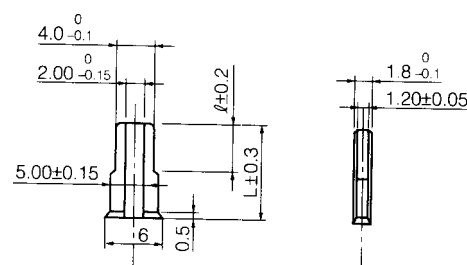

## OUTPUT LAW

Linear (B)

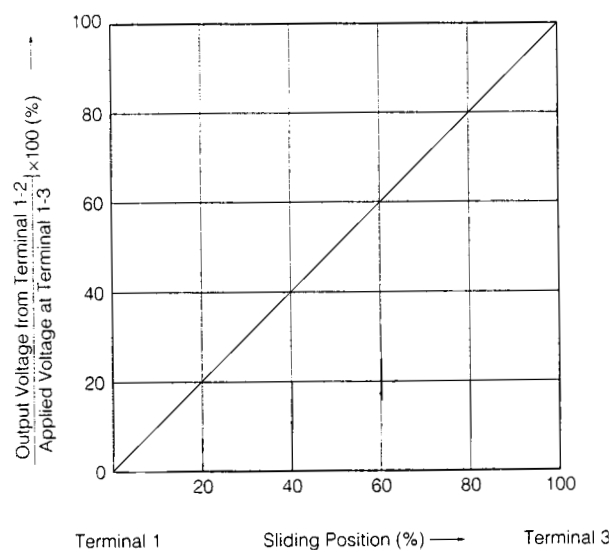

Logarithmic (D)

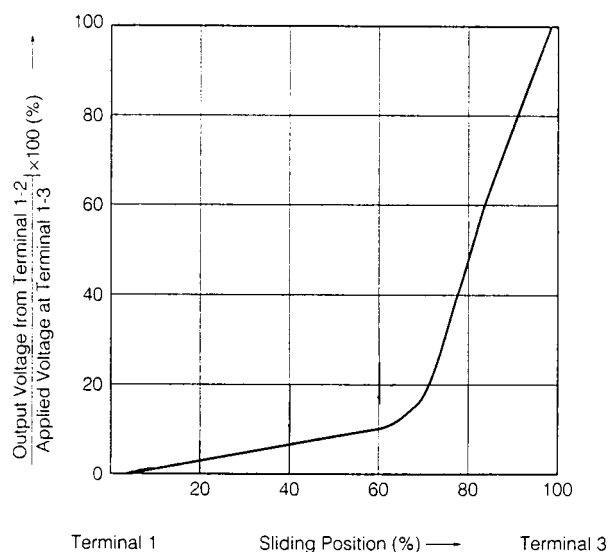

## POWER DERATING CURVE

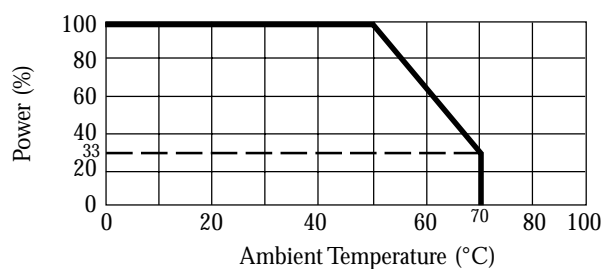

## PREFERRED STYLES/VALUES

Travel	Values Available	Law
15mm	10K, 100K,	Linear
45mm	10K, 50K, 100K	Linear / Log
60mm	10K, 50K, 100K	Linear / Log

## HOW TO ORDER

COMMON PART			OUTPUT LAW	RESISTANCE VALUE	LEVER
Style	No Detent	Detent			
15mm Single	WAKFF	WAKFE			
15mm Dual	WAKA2	WAKAO			
20mm Single	WAMFF	WAMFE			
20mm Dual	WAMA2	WMAAO			
30mm Single	WANFD	WANFE			
30mm Dual	WANA5	WANA0			
45mm Single	WAPFF	WAPFE			
45mm Dual	WAPA2	WAPAO			
60mm Single	WAQFF	WAQFE			
60mm Dual	WAQA2	WAQAO			
			B - Linear D - Log	The first two digits are significant figures of resistance value and the third one denotes the number of zeros following.  Example: 10K : 103 20K : 203 100K : 104	C15



Meggitt Electronic Components Ltd. Ohmic House, Westmead Industrial Estate, Swindon, Wilts. SN5 7US  
 Telephone: (01793) 487301 (Admin.) (01793) 611666 (Sales) Email: sales@megelec.co.uk Fax: (01793) 611777

This publication is issued to provide outline information only and (unless specifically agreed to the contrary by the Company in writing) is not to form part of any order or be regarded as a representation relating to the products or service concerned. We reserve the right to alter without notice the specification, design, price or conditions of supply of any product or service. Whilst Meggitt Electronic Components products are of the very highest quality and reliability, all electronic components can occasionally be subject to failure. Where failure of a Meggitt Electronic Components product could result in life threatening consequences, then the circuit and application must be discussed with the Company. Such areas might include ECG, respiratory, and other medical and nuclear applications and any non fail safe applications circuit.